

SKETCH FROM NORTH-WEST APPROACH

CARPARKING AREA

hulena
 HULENA ARCHITECTS LIMITED
 9 MELROSE STREET
 NEWMARKET
 AUCKLAND
 NEW ZEALAND
 T 09 524 6955
 F 09 520 6522
 E OFFICE@HULENA.COM
 WWW.HULENA.COM

THE COPYRIGHT TO THESE DRAWINGS AND ALL PARTS THEREOF IS THE

SITE PLAN

1:500

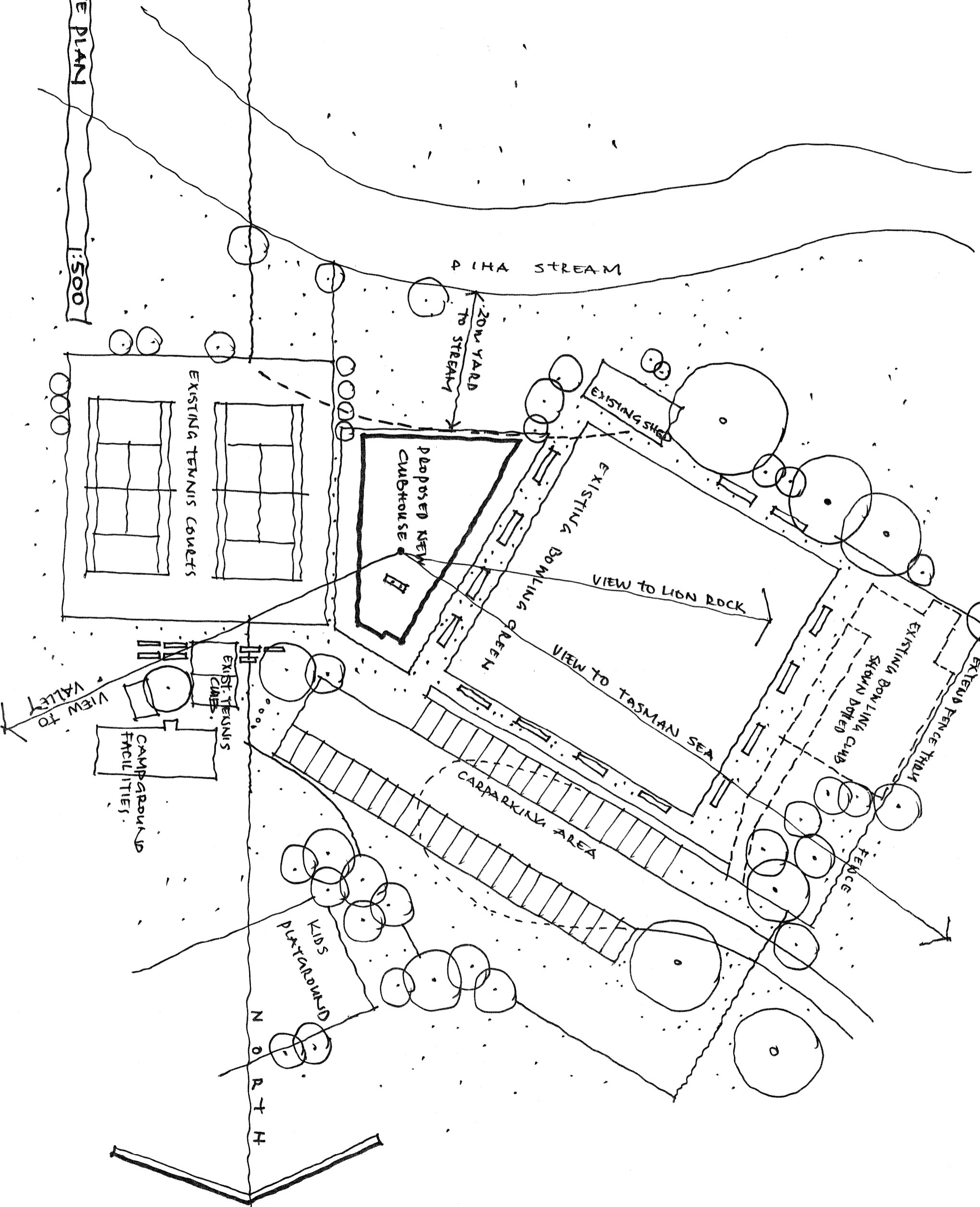

hulena
 HULENA ARCHITECTS LIMITED
 9 MELROSE STREET
 NEWMARKET AUCKLAND
 NEW ZEALAND
 T 09 524 6955
 F 09 520 6522
 E OFFICE@HULENA.COM
 WWW.HULENA.COM

THE COPYRIGHT TO THESE DRAWINGS AND ALL PARTS THEREOF IS THE

PIHA STREAM

UTILITIES+WATER STORE AREA
RAINWATER TANKS

EXISTING SHED

EXISTING BOWLING GREEN

CARPARKING AREA

N O R T H

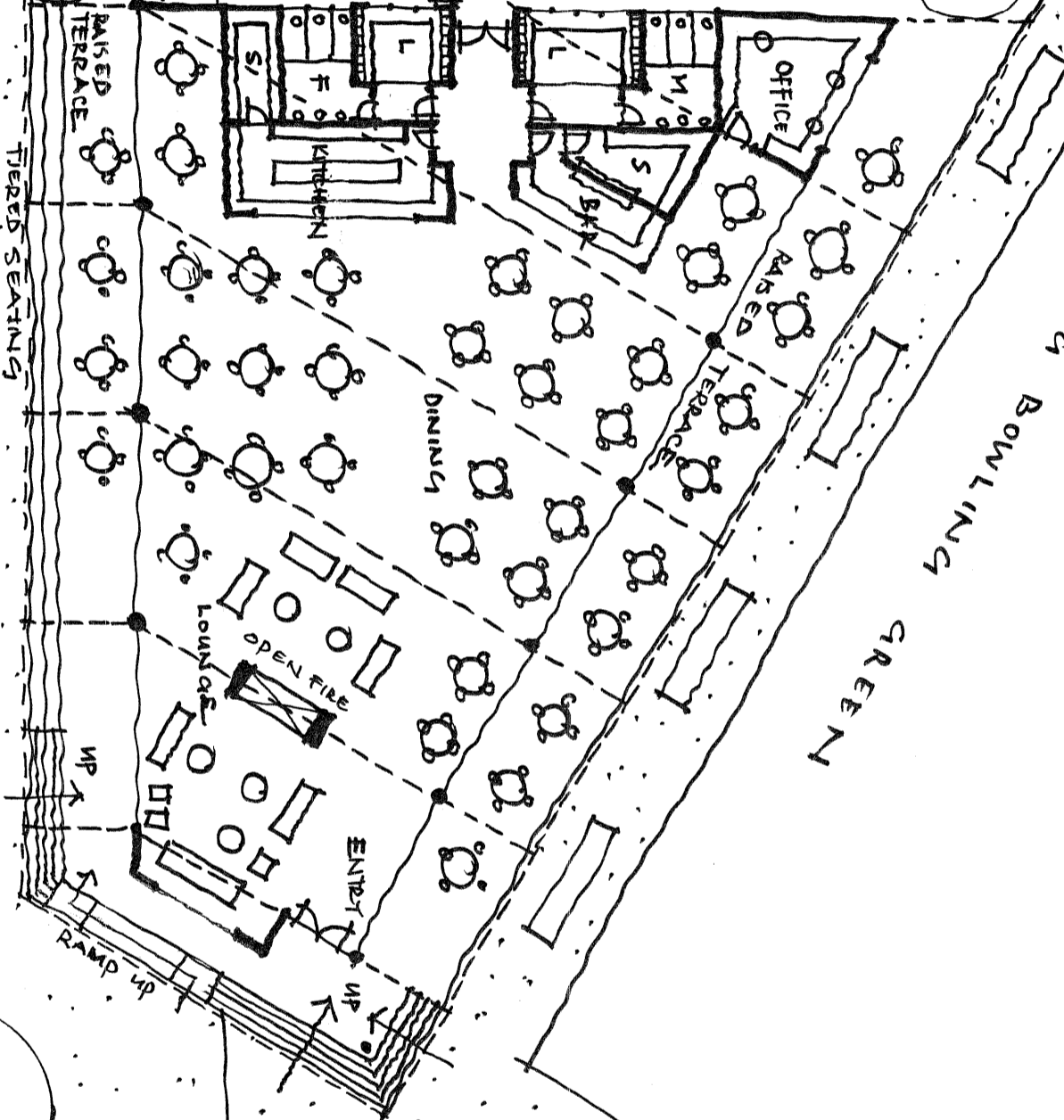

FLOOR PLAN

1:200

EXISTING TENNIS COURTS

PIHA DOMAIN

SPORT + RECREATION

CLUBHOUSE

CONCEPT

EXISTING TENNIS CLUB

JANUARY 2011

4592.053

hulena.
 HULENA ARCHITECTS LIMITED
 9 MELROSE STREET
 NEWMARKET
 AUCKLAND
 NEW ZEALAND
 T 09 524 6955
 F 09 520 6572
 E OFFICE@HULENA.COM
 WWW.HULENA.COM

THE COPYRIGHT TO THESE DRAWINGS AND ALL PARTS THEREOF IS THE